

| ITEM NO. | QTY. | PART NUMBER | DESCRIPTION | REF NOTE |
|----------|------|-------------|--|----------|
| 1 | 2 | 101073-2 | 1/4" NPT MALE ELBOW, COMPRESSION | |
| 2 | 4 | 211038 | TEMP. SWITCH, 425F N.C. | |
| 3 | 1 | 230164 | COMP. MODULE, OMC, 20/25/30 HP 2-STAGE, SIMPLEX LESS MOTOR | |
| 4 | 1 | 232266 | RELIEF VLV, 1/2" 175 PSIG/316 SCFM | |
| 5 | 1 | 244286 | MOTOR, 25HP, 1770RPM, ODP, 284T | |
| 6 | 1 | 246029 | SOLENOID VALVE, 1/4" 3-WAY | |
| 7 | 4 | 248008 | 4"x4"x7/8" VIBRATION PAD | |
| 8 | 1 | A-12100-2 | 1/2" NPT STREET ELBOW | |
| 9 | 5 | A-12541-1 | ENTRANCE ELBOW W/ GASKET, 1/2" NPT | |
| 10 | 1 | A-12616-1 | | |
| 11 | 1 | B-12103-9 | 1-1/2 to 1/2" NPT BUSHING | |
| 12 | 1 | B-12105-8 | 1-1/2" NPT CLOSE NIPPLE | |
| 13 | 1 | B-12108-8 | 1-1/2" Threaded Tee | |

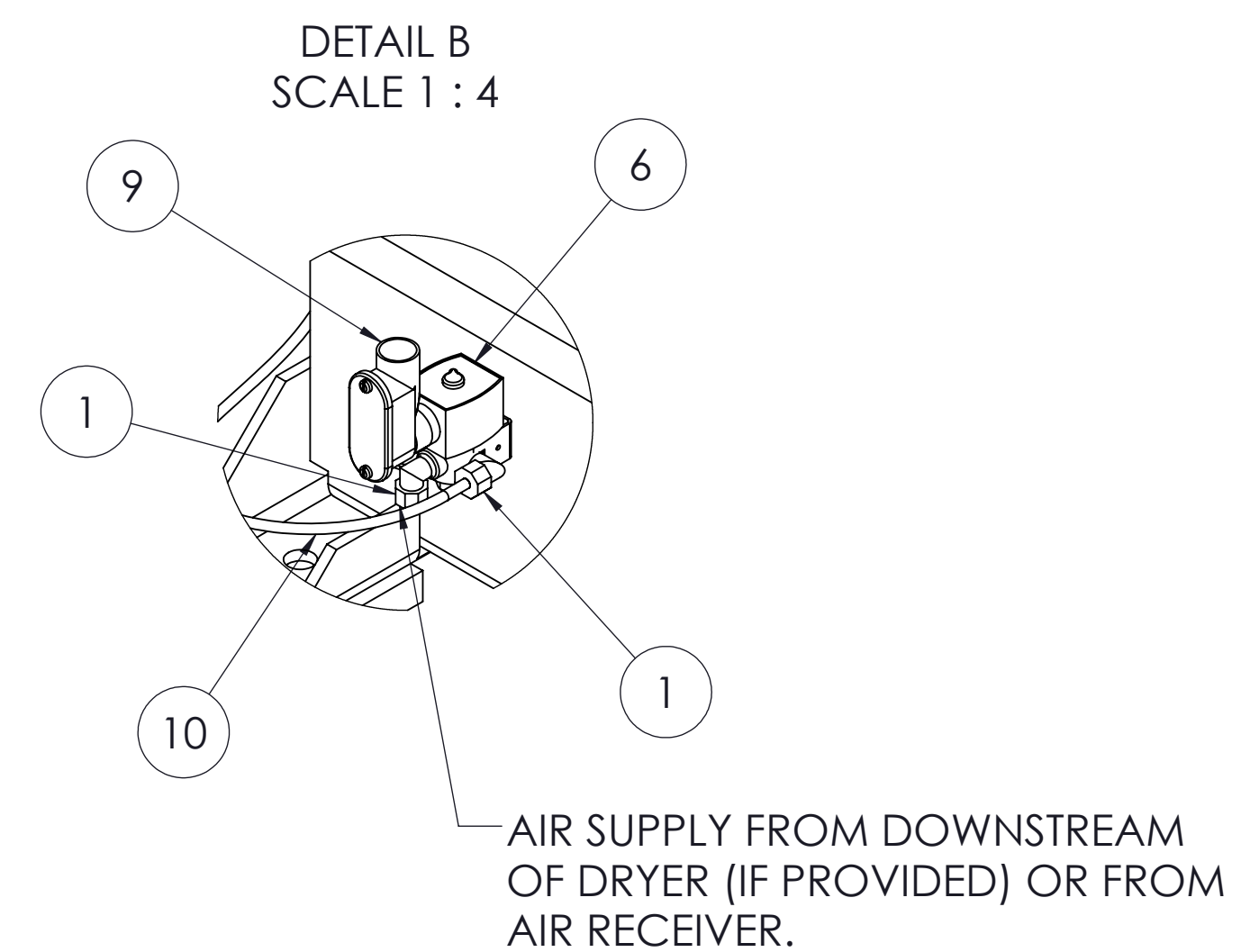

2-1/2" NPT AIR INLET
CONNECTION.
2-OPTIONAL LOCATIONS

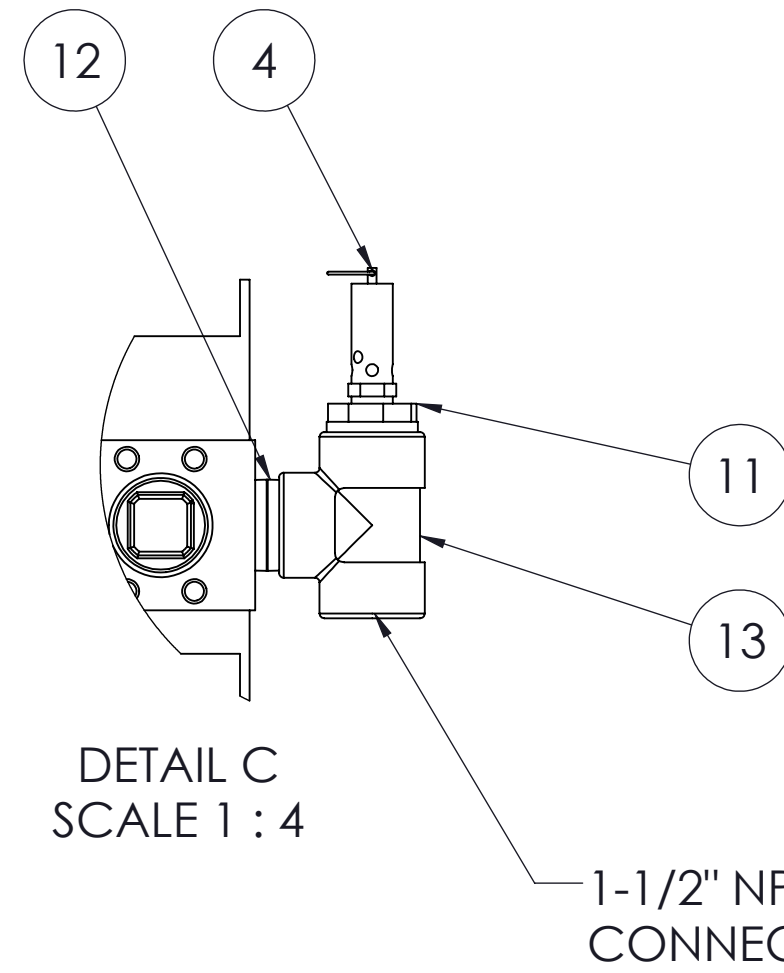
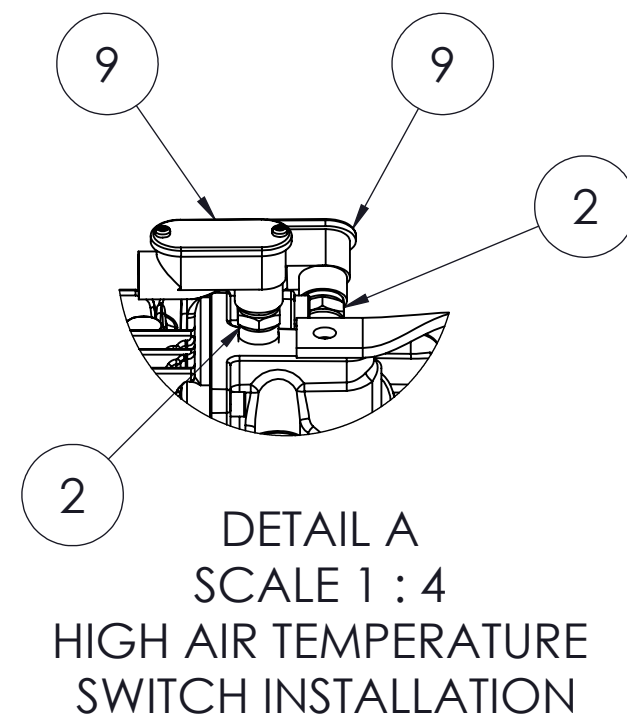
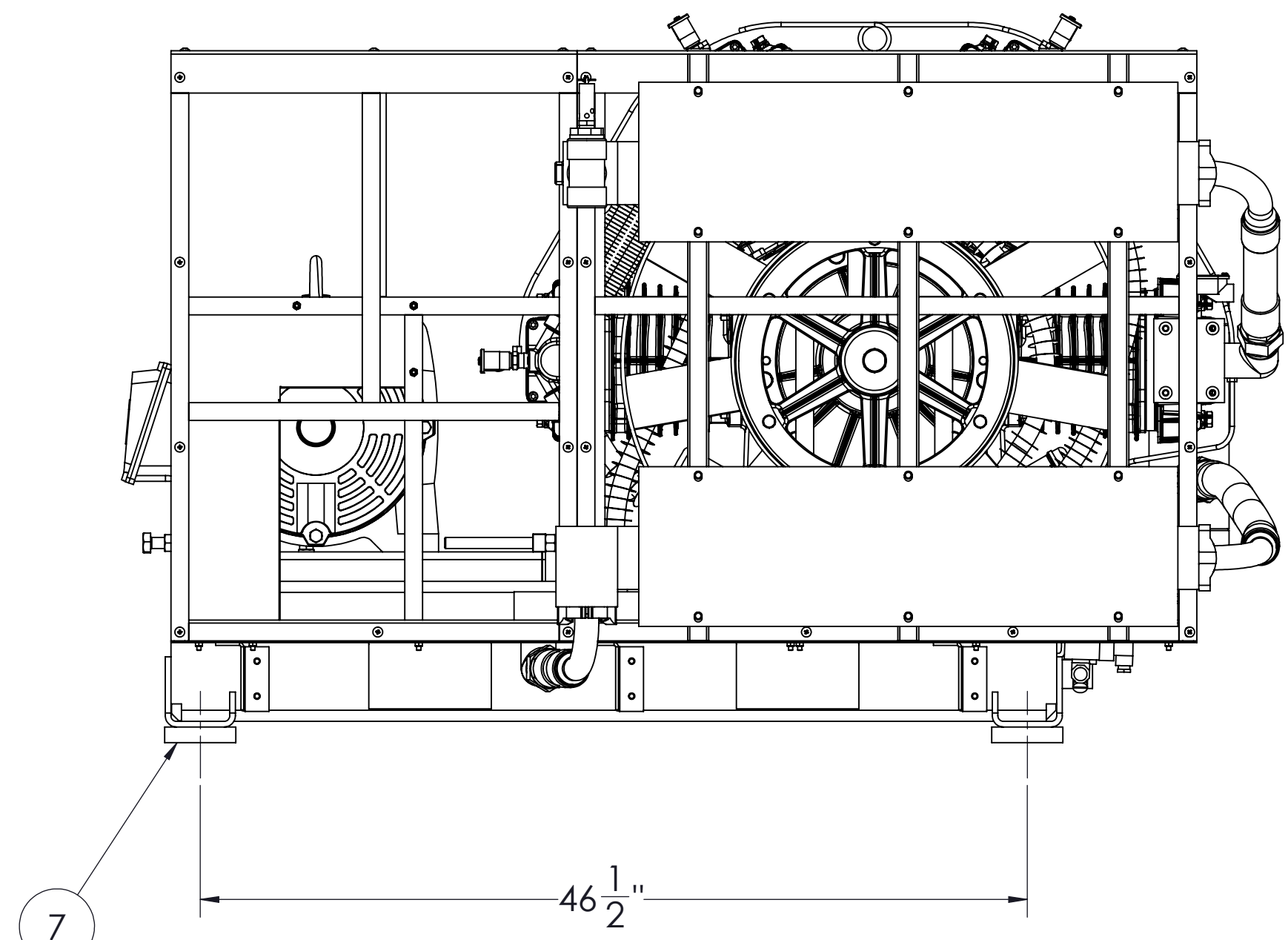
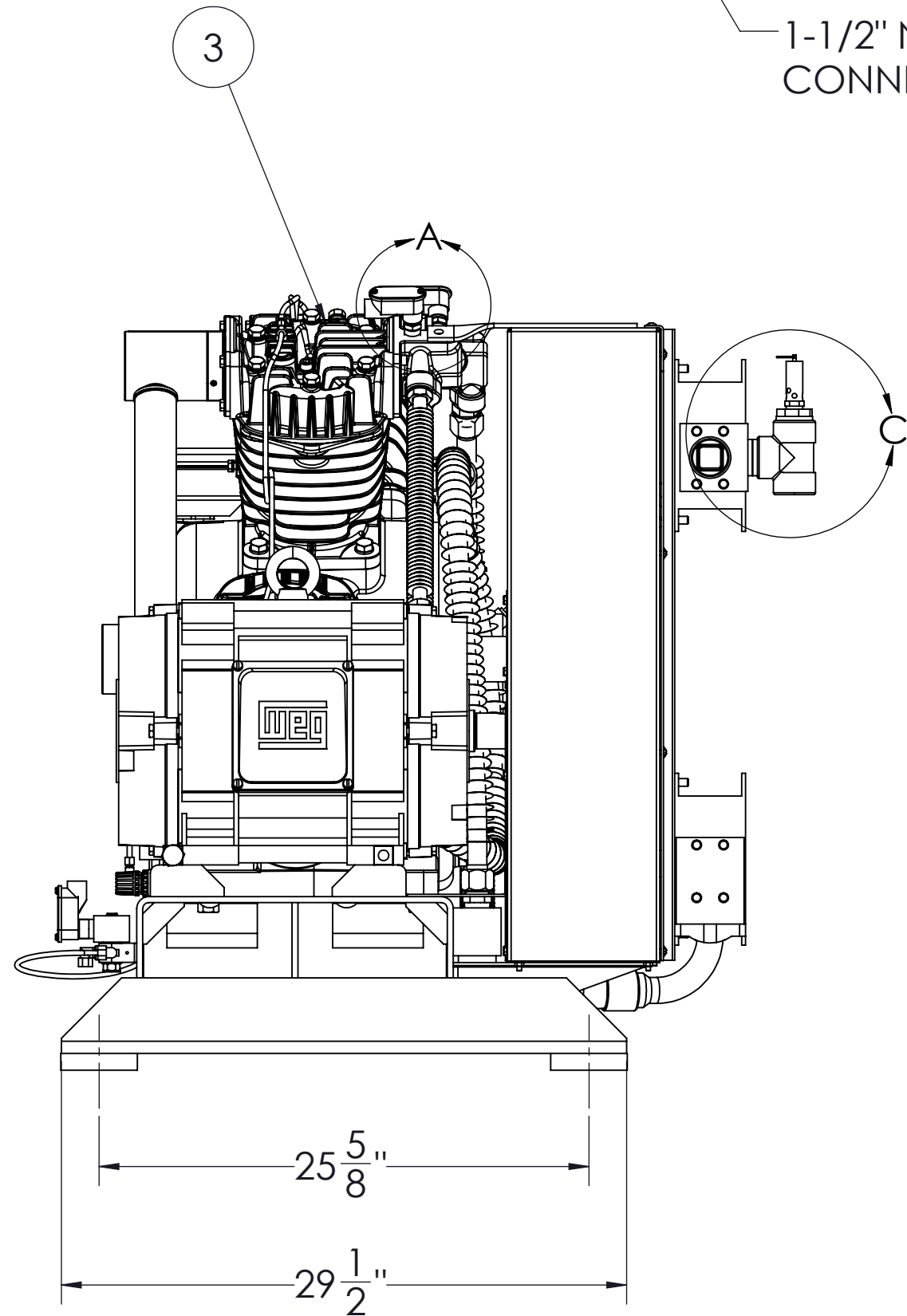
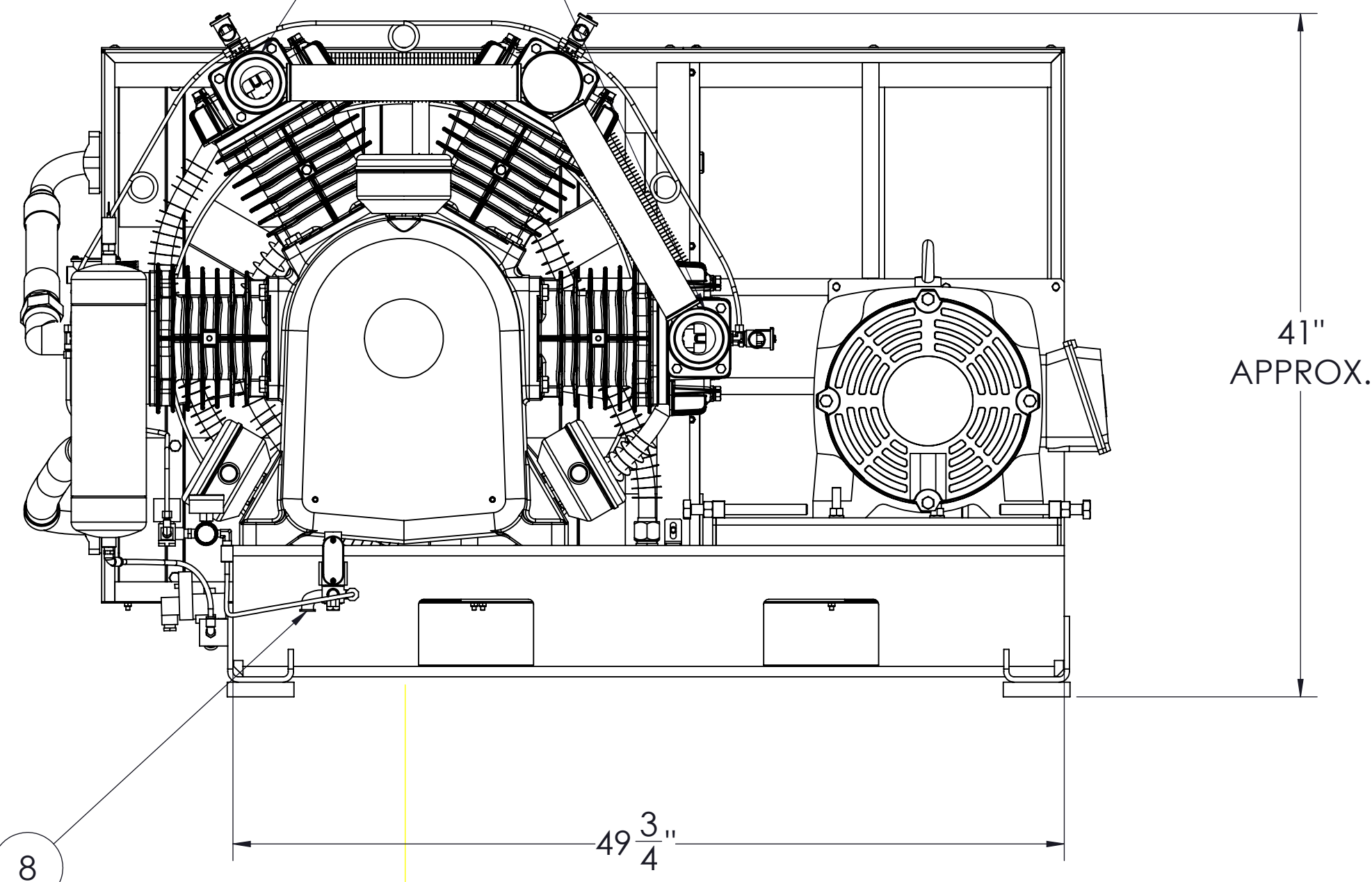

| | | | | |
|--|--------------|-----------------------|----------|------|
| 01 | N/A | INITIAL RELEASE | 06/22/20 | F.L. |
| REV | CR. NO. | DESCRIPTION OF CHANGE | DATE | BY |
| <small>DO NOT SCALE DRAWINGS UNLESS OTHERWISE SPECIFIED: DIMENSIONS ARE IN INCHES AND TOLERANCES ARE: .XX ± 0.1 .XXX ± 0.03 X.XXX ± 0.005 XXX ± 1"</small> | | | | |
| DRAWN BY | | DATE | | |
| F. LOPEZ | | 06/22/20 | | |
| CHECKED BY | | DATE | | |
| APPROVED BY | | DATE | | |
| <small>THIRD ANGLE PROJECTION</small> | | | | |
| ITEM DESCRIPTION: | | | | |
| RECIPROCATING AIR COMPRESSOR MODULE, 25HP HIGH PRESSURE 208-230/460V | | | | |
| FINISH | DWG. SIZE | SCALE | REV | |
| | B | SCALE: 1:8 | 01 | |
| FILE NAME | SHEET 1 OF 1 | | | |
| 100-0265.SLDDRW | | | | |

100-0265

CONFIDENTIAL: THIS DRAWING AND THE DESIGN REPRESENTED THEREIN ARE THE PROPERTY OF OHIO MEDICAL, LLC AND HAS BEEN ISSUED WITH THE UNDERSTANDING THAT NEITHER DRAWING NOR THE INFORMATION THEREIN IS TO BE USED OR DISCLOSED, EITHER IN WHOLE OR IN PART, EXCEPT AS SPECIFICALLY AUTHORIZED BY OHIO MEDICAL, LLC AND SHALL BE RETURNED UPON REQUEST.